

DEMOLITION SCOPE OF WORKS:

1. EXISTING SERVICES IMPACTED BY JOINERY REMOVAL /TEACHING WALL WORKS SHALL BE DECOMMISSIONED AND REMOVED. CONTRACTOR SHALL VALIDATE EXISTING CABLING/SERVICES WITHIN THESE AREAS AND RETAIN / REINSTATE ANY POWER, DATA, SECURITY OR PUBLIC ADDRESS DEVICES.
2. DECOMMISSION, REMOVE AND MAKE GOOD THE FOLLOWING (WHERE AFFECTED BY THE DEMOLITION WORKS): - THE EXISTING ELECTRICAL SERVICES MADE REDUNDANT BY THE NEW FIT-OUT WORKS SCOPE. REFER TO THE ELECTRICAL AND ARCHITECTURAL SET TO UNDERSTAND THE GREATER SCOPE OF WORK FOR THIS PROJECT. MAKE GOOD SURROUNDING AREA OF REMOVAL IN PREPARATION FOR BUILDING WORKS. CONTRACTORS SHALL VISIT SITE DURING THE TENDERING PERIOD AND ASCERTAIN WHAT SERVICES ARE AFFECTED BY THE DEMOLITION.
3. EXISTING SERVICES SHALL REMAIN / RELOCATE AS FOLLOWS:
 - EXISTING COMMUNICATIONS RACK
 - NON-COMPLIANCE WITH LATEST STANDARD, CONTRACTOR TO COORDINATE WITH SCHOOL IF REPLACEMENT IS REQUIRED
 - UNLESS IMPACTED BY DEMOLITION OR PROPOSED WORKS, ALL EXISTING SERVICES SHALL REMAIN
4. TRAVERSING, INTERCONNECTING DEVICES
 - THE ELECTRICAL / COMMS / SECURITY HAVE CABLING / INTERFACES TRAVERSING THROUGH AREAS SUBJECT FOR DEMOLITION, ASCERTAIN THESE EXISTING CABLES / SYSTEMS ON SITE PRIOR TO DEMOLITION WORKS. THESE SYSTEMS SHALL BE CAREFULLY RETAINED AND OPERATIONAL IN ENTIRETY DURING WORKS AND IN SOME CASES RECONNECTED.
 - ELECTRICAL CONTRACTOR SHALL ENSURE ALL EXISTING SYSTEMS OUTSIDE OF THIS SCOPE SHOWN STILL OPERATE WITHOUT DISRUPTION.
 - CONTRACTOR IS TO VISIT SITE DURING THE TENDER PERIOD TO ENSURE THEIR TENDER PRICE ALLOWS FOR THESE INTERCONNECTING SYSTEMS.
5. DISCONNECT, REMOVE, SECURELY STOCKPILE AND REINSTATE THE FOLLOWING EXISTING DEVICES, FIXTURES, FITTINGS, EQUIPMENT AND SECURELY STOCKPILE THEM BY BUILDER READY FOR REINSTATEMENT AT PRACTICAL COMPLETION BY BUILDER AND RESPECTIVE SUB-TRADES. (NOTE: BUILDER AND SUB-TRADES SHALL NOTIFY PROJECT SUPERINTENDENT FOR METHODOLOGY OF STOCKPILING / STORAGE).
 - ALL EXISTING FIXTURES, FITTINGS AND DEVICES LOCATED ON BUILDING ELEMENTS, MATERIALS AND FABRICS THAT ARE SUBJECT TO REMOVAL AND REINSTATEMENT BY THE ARCHITECTURAL SCOPE OF WORKS. (E.G. CEILING, GRID, TILES, ETC).

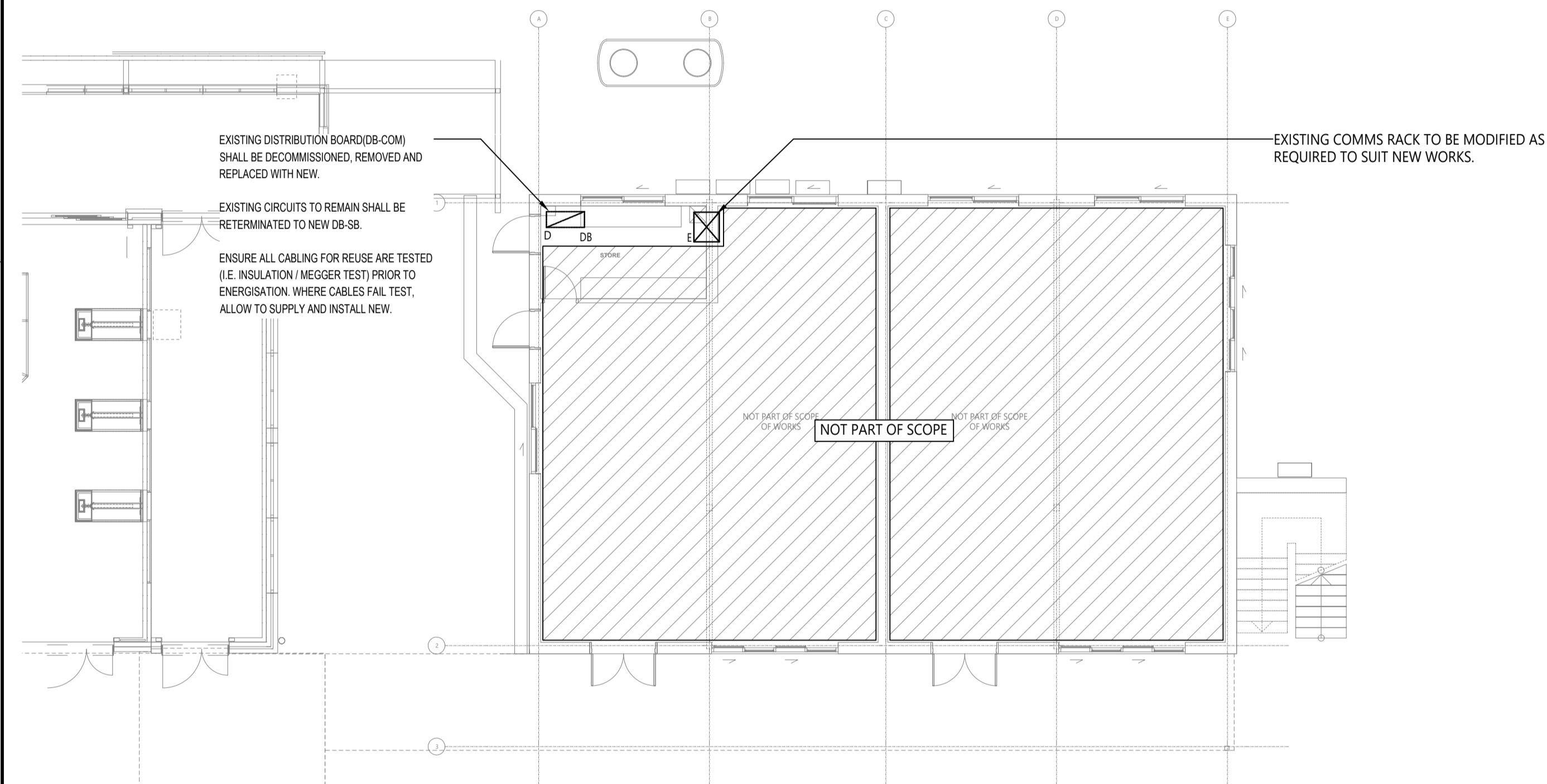

GROUND LEVEL
EXISTING & DEMO PLAN
SCALE 1:100

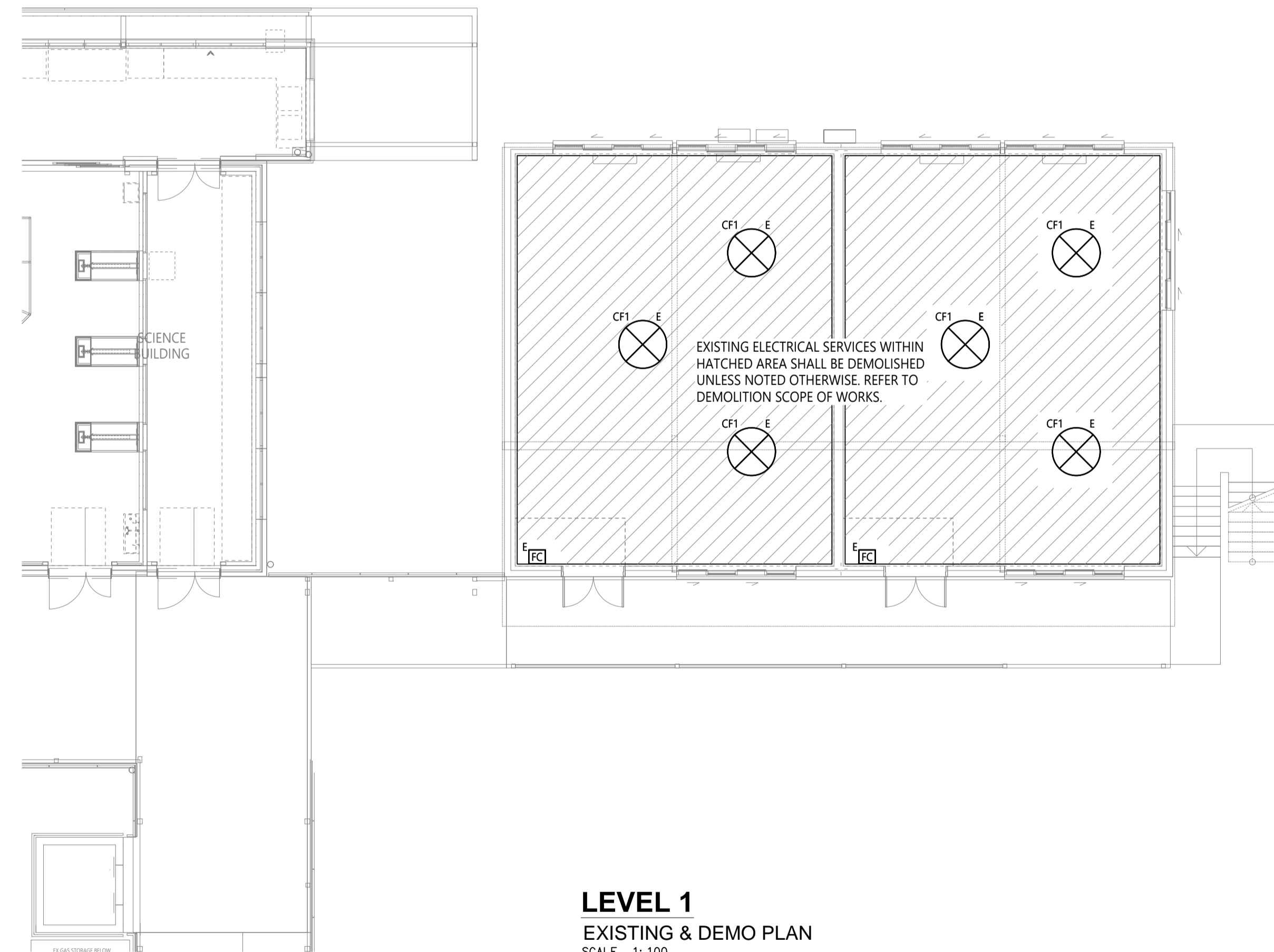

LEVEL 1
EXISTING & DEMO PLAN
SCALE 1:100

ELECTRICAL DESIGN GROUP BRISBANE
PTY LTD
ACN 092 710 793
TRADING AS:
ELECTRICAL DESIGN GROUP

THE COPYRIGHT OF THIS DRAWING
REMAINS THE PROPERTY OF THE
ELECTRICAL DESIGN GROUP.
USE FIGURED DIMENSIONS
IN PREFERENCE TO SCALE.
ALL DIMENSIONS TO BE
VERIFIED ONSITE.



E: info@aswelectrical.com.au
M: 0450 440 569
www.aswelectrical.com.au

ELECTRICAL DESIGN GROUP
ELECTRICAL BUILDING SERVICES CONSULTANTS
BRISBANE GOLD COAST

P.O. Box 15, Sherwood Q.4075
Phone: (07) 3278 4375
Email: brisbane@edg.net.au
Web: www.edg.net.au

PROJECT:
**JOHN PAUL COLLEGE
SCIENCE CLASSES**

125 JOHN PAUL DRIVE, DAISY HILL, QUEENSLAND

B	AS CONSTRUCTED	14/01/2025
REV:	DESCRIPTION:	DATE:

DRAWING:
**ELECTRICAL SERVICES
EXISTING & DEMO PLANS**

SCALE:
1:100

AT A1

PROJECT NO:
C3406a

DRAWING NO:
E04

REVISION:
B